

SERVICE MANUAL BAGLESS CYLINDER VACUUM CLEANER



Dear customer, we thank you for purchase of goods «Maestro». Functionality, design and conformity to the quality standards guarantee to you reliability and convenience in use of this device.

Please read and comply with these original instructions prior to the initial operation of your appliance and store them for later use of subsequent owners.

The cylinder vacuum cleaner is intended for home use only.

Under condition of observance of user regulations and a special-purpose designation, a parts of appliance do not contain unhealthy substances.

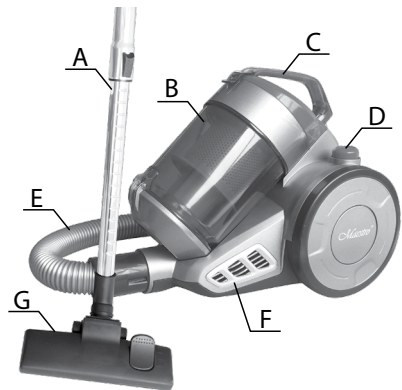
Technical specifications	Description of the appliance	
Model MR609 Electrical supply: Alternating current- AC; Rated voltage 220-240V; Rated frequency 50Hz; Power consumption 1400W Protective class II Protection class IPX0	A. Telescopic tube B. Dust container C. Handle D. ON/OFF switch -power regulator E. Hose F. Ventilation inlets G. Universal nozzle "floor/carpet"	

Safety instructions

When using your appliance, basic safety precautions should always be followed, including the following:

ATTENTION!

- Do not immerse the appliance or power cord and plug in water or other liquids, keep it away from rain and moisture.
- The appliance must always be unplugged before cleaning or maintenance takes place.
- Never touch the plug with wet hands. Do not operate the appliance outside or in rooms with a high level of humidity.

Failure to observe these rules may result in electric shock!

- DO NOT leave the appliance unnecessarily plugged in. Disconnect the plug from the mains when the appliance is not being used.
- DO NOT leave the appliance exposed to the weather (rain, sun, etc.).
- In the interest of safety, regular periodic close checks should be carried out on the supply cord to ensure no damage is evident. Should there be any signs that the cord is damaged in the slightest degree, the entire appliance should be returned to authorized service engineer.
- This appliance is not intended for use by persons (including children) with reduced physical, sensory or mental capabilities, or lack of experience and knowledge, unless they have been given supervision or instruction concerning use of the appliance by a person responsible for their safety.
- Never carry the appliance by its power cord. It could be damaged.

ATTENTION! Particularly prohibited:

- Use in the vicinity of explosive or highly-flammable substances. There is a risk of fire or explosion.
- To use the appliance outdoors. There is danger of rain or dirt destroying the appliance.
- Sticking objects into the appliance's openings. It could overheat.
- To modify or repair the appliance yourself.
- Vacuuming of:
 - Persons, animals, plants, especially hair, fingers and other parts of the body as well as articles of clothing on the body. These might be drawn in. This could result in injuries.
 - Water and other fluids, especially damp carpet cleaners. Moisture inside the appliance can cause a short-circuit.
 - Toner (for laser printers, copying machines, etc.). There is danger of fire or explosion.
 - Hot ash, burning cigarettes or matches. This could cause a fire.
 - Pointed objects, such as glass shards, nails, etc. They can damage the appliance.
 - Rubble, plaster, cement, fine drilling-dust, make-up, etc. These might damage the appliance.

- THIS APPLIANCE IS FOR HOUSEHOLD USE ONLY. DO NOT USE THE APPLIANCE FOR ANYTHING OTHER THAN INTENDED USE.
Purchase industrial devices for commercial use.

Operation

Before the first use:

- Remove packing and advertising materials and stickers.
- Unwind the power line cord completely.
- Inspect the appliance and make sure that there are no damages to the device, power line cord, and plug.

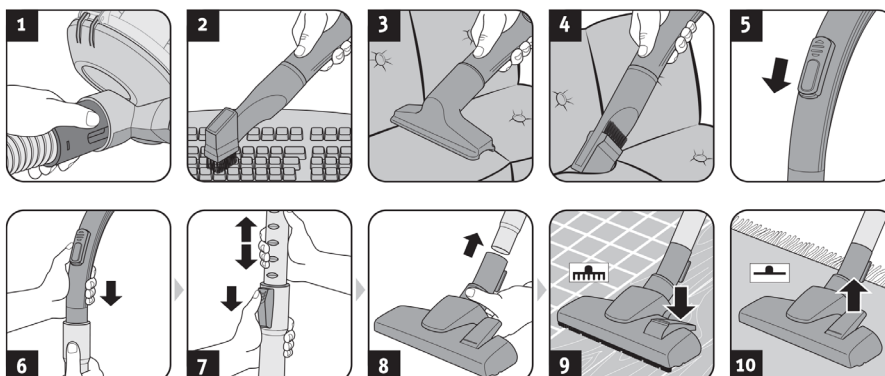

Assembling:

1. Assemble the appliance and accessory parts depending on the surface you want to vacuum clean (Fig. 1 - 8).
2. Ensure that the bypass vent is shut (Fig. 5).
3. If you use the telescopic tube (Fig. 6), adjust its length (Fig. 7).
4. If you use the floor nozzle (Fig. 8), set it to the floor to be cleaned (Fig. 9 hard floor, Fig. 10 carpet).

USE:

1. Pull the cable out of the appliance (Fig. 11) and plug into a socket.

WARNING: Danger of electric shock! If the red marking shows (Fig. 12) retract the cord by pressing the retraction button to pull in the cord up to the yellow mark (Fig. 13) again. Otherwise, the power cord may be damaged.

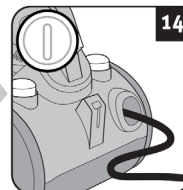
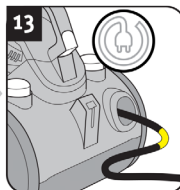
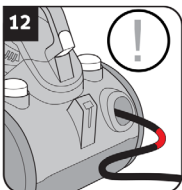
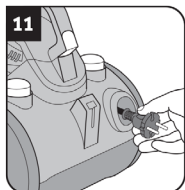

2. Switch on the appliance using the on/off switch (Fig. 14).

NOTE: The auxiliary air regulator (Fig. 5) must be completely closed for vacuum cleaning. With the auxiliary air regulator you can quickly reduce the suction power, to release objects (such as curtains) that have been sucked in.

3. Vacuum clean (Fig. 15).

Cleaning and maintenance

The dust container has to be emptied and cleaned regularly. Otherwise emptying it will get harder and harder or smells and bacteria might develop, depending on what you have vacuumed up. Therefore, it is best to empty the dust container after each vacuuming session. Empty and clean the dust container at the latest when the cleaning/ emptying display lights up (Fig. 16).

ATTENTION!

- Never clean the appliance connected to mains. Before cleaning disconnect the device and wait for full stop of moving parts.
- Never submerge motor unit, its mains cable and plug in water or other liquid.

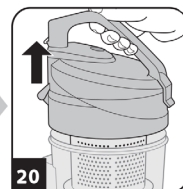
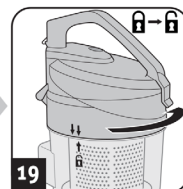
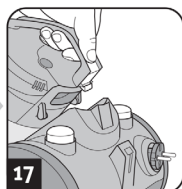
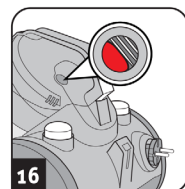

1. Switch off the appliance, pull the plug out of the plug socket.

2. Remove the dust container (Fig. 17), empty the dust container (Fig. 18).

3. Take this opportunity to also check the filter elements (dual motor protection filter and cyclone unit) in the dust container (Figures 19 - 22). Remove all residual dust adhering to the dust container. Use only a dry cloth to do this, or, if necessary, a brush with soft bristles (Fig. 23).

4. If the dual motor protection filter is dirty, clean it under cold or lukewarm running water (Fig. 24) until all dirt is gone.

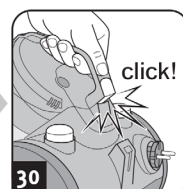
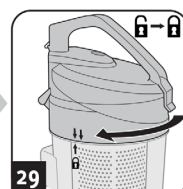
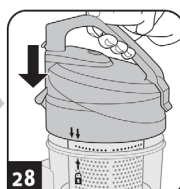
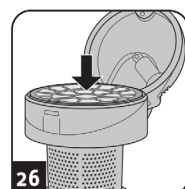
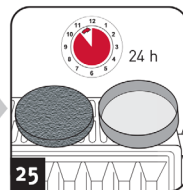
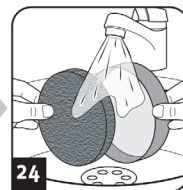
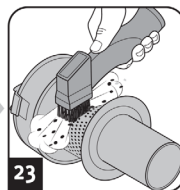

CAUTION: The dual motor protection filter is washable, but it may not be cleaned in dishwashers or washing machines. Also, do not use detergents or brushes with hard bristles. Let the filter elements of the dual motor protection filter dry (for approx. 24 hours at room temperature, Fig. 25) after wet cleaning.

5. Put the filter elements back in (Fig. 26 - 29).

NOTE: The filter elements are constructed so that they will only go all the way down if in the right position. Nevertheless, it is helpful if you align the cyclone unit to the dust container as shown in Fig. 28 before insertion. Do not use force upon insertion. If the dust container lid (Fig. 29) will not shut properly, then you have to take the parts out again and put them back in.

CAUTION: Never operate the appliance without the filter elements in place. Never operate the appliance with damaged filter elements.

6. Re-insert the dust container (fig. 30). You should feel and hear it click into place.

Storage

- Before storage disconnect the device and wait for full stop of moving parts. Clean the appliance before storage.
- Store the device in a cool, dry and clean place beyond the assess of children and people with limited physical and mental abilities.

Environmental protection

Old appliances contain valuable materials that can be recycled. Please arrange for the proper recycling of old appliances. Please dispose your old appliances using appropriate collection systems.

Subject to technical modifications!